

# Trial Frame - ESS204

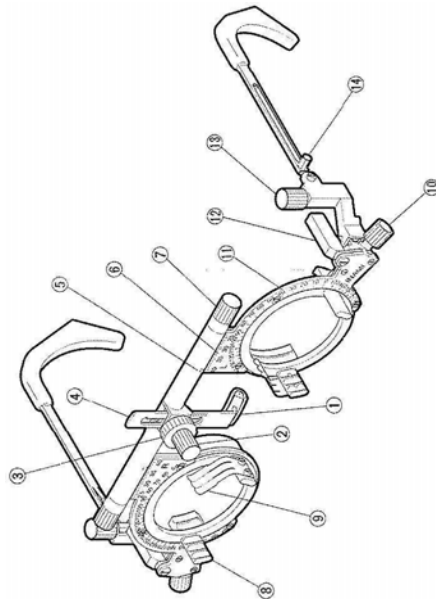

## DESCRIPTION

Class I device (without measuring function)

- (1): Nose pad
- (2): Nose pad adjustment knob
- (3): Nose pad position fixation knob
- (4): Nose pad adjustment plate
- (5): The Index for PD Measuring
- (6): The Measure for PD
- (7): PD adjustment knob
- (8): Lens Holder
- (9): Lens fixation plate
- (10): Lens rotation knob
- (11): The Measure for the axis of the cylinder
- (12): The Measure for the position of the Cornea
- (13): Frame up—down adjustment knob
- (14): Frame length adjustment knob

## IN STORAGE

Humidity: 10, 95%  
Temperature : -10, 55°C

## USE

### *Before operation*

Before wear it for patient, kindly pre-check the movement of all knobs to avoid any problem during in operation.

### *Preparation of operation*

Before starting to insert the lens, please make sure the correctly fitting for patient eye, such as PD and length of the bridge etc. If incorrect, the measuring result will be changed.

### *After use*

After use it, keep clean and wipe with soft cloth.

## TECHNICAL SPECIFICATIONS

PD distance: 48-80mm ( $\pm 0.8$ mm)  
Cornea measuring plate: 2mm  
Frame adjustable angles: 35° (high 30° $\pm 5^\circ$ , low 5°  
+5°,-2°)  
Frame adjustable length: 35mm  
Axes: 0° $\pm 5^\circ$ , 180° $\pm 5^\circ$   
Dimensions: 80 × 40 × 23 mm  
Weight (product alone): 66 g  
Weight (with packaging): 129 g  
Life cycle: 10 years

The information contained in this document is provided as information only and is not contractually-binding. It may be modified without notice. In a document of this type, errors or omissions may occur, even though everything has been done to avoid them. Essilor shall not be liable for any malfunctions resulting from such errors or omissions.

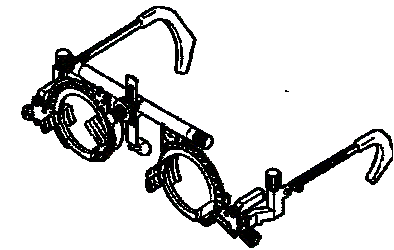

## Essilor Instruments USA

8600 W. Catalpa Avenue, Suite 703

Chicago, IL 60656

Phone: 855.393.4647

Email: [info@essilorinstrumentsusa.com](mailto:info@essilorinstrumentsusa.com)

[www.essilorinstrumentsusa.com](http://www.essilorinstrumentsusa.com)